

SPECIAL FIXING ACCESSORIES

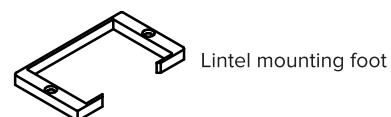

Lintel mounting foot



screw M4 x 10 for mounting between the brackets and the guides



Ceiling L mounting bracket



galvanised grub screw M5 x 20 for guide coupling

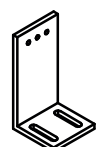

Front L mounting bracket

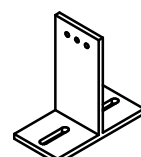

bracket T from front mounting for coupled blinds

DESCRIPTION OF BASIC LUME COMPONENTS

tilter hub

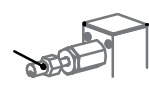

adapter



motor



Lift limit stop



box block foot

handling channel



clip coupling key

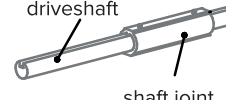

driveshaft

shaft joint

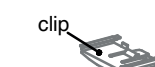

clip

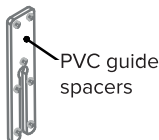

PVC guide spacers

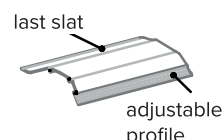

last slat adjustable profile



guide level yellow grub screws M5 x 10



INSTRUCTION MANUAL FOR INSTALLING LUME - LUME ESSE

CAREFULLY READ THE MANUAL BEFORE INSTALLING

Lupak Metal Venetian blind systems must be installed and powered only by authorised personnel.

EXAMPLE OF GROUND AND CEILING FIXING

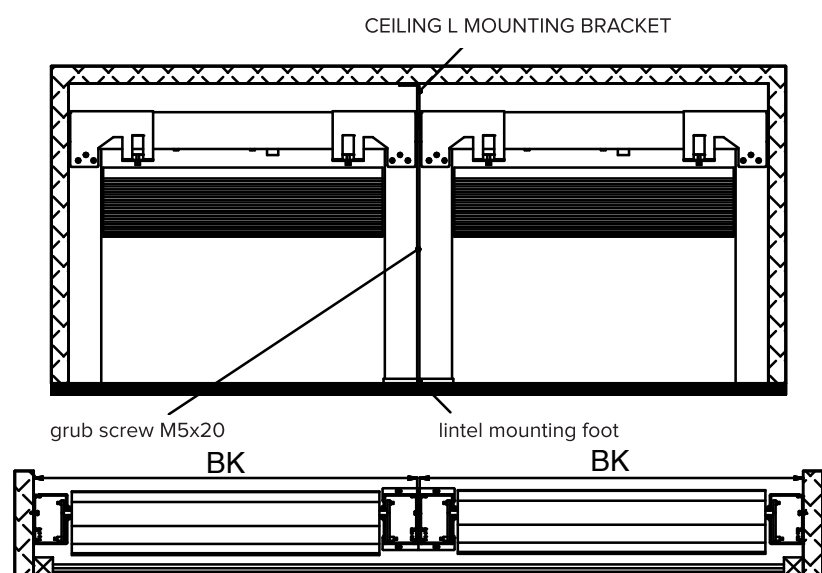

TROUBLESHOOTING TABLE

PROBLEM	POSSIBLE REASON	SOLUTION
The last slat does not close completely	Misaligned guides	Check guide tolerances (INSTALLATION TOLERANCES)
	Fixing screws too tight	Loosen the fixing screws.
	Adjustable rubber profile too long	Correctly adjust the rubber profile
The motor runs only in one direction	Connection error	Check connection on provided schematics
	Incorrect limit stop adjustment	Correctly adjust the limit stop (see motor instructions)
The motor stops suddenly	Motor heat protection tripped	Wait 10 minutes.
The blinds come down in jerks	Installation out of tolerance	Check BK tolerance
The blinds are very noisy	The box screws are loose	Tighten the screws

IN THE EVENT OF OTHER ISSUES, DO NOT USE THE VENETIAN BLINDS AND CONTACT CUSTOMER SERVICE.



LA LUCE A MODO TUO



Assembly cover panels Chain



Assembly Chain system

Lupak Metal srl
48018 Faenza RA Italy
via Granarolo, 77
T +39 0546 646140
lupakmetal.com

REV
04 / 2023

EXAMPLE OF FRONT FIXING

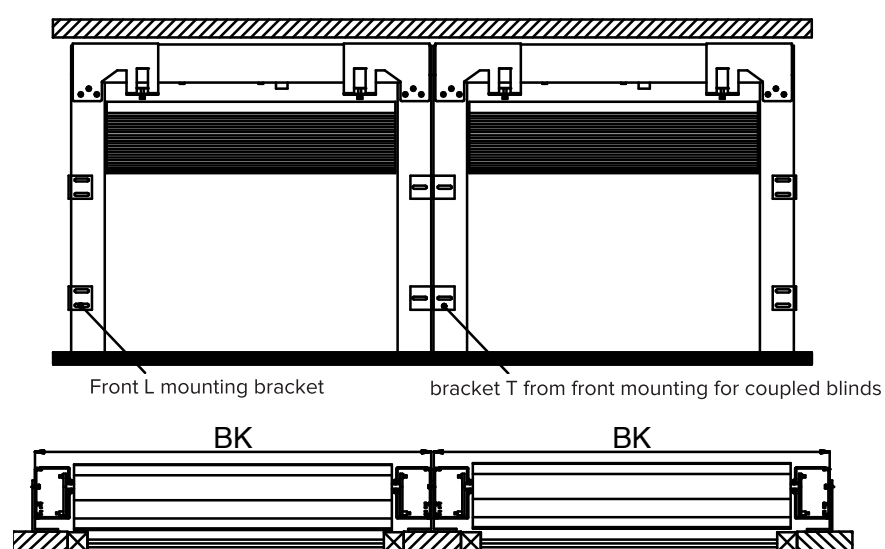

INSTRUCTIONS FOR INSTALLERS

BEFORE INSTALLATION, ENSURE THAT THERE IS NO POWER AND THAT ALL ELECTRICAL CONNECTIONS ARE CREATED BY QUALIFIED TECHNICIANS.

INSTALLATION INFORMATION:

- The weight of the guides must rest on the floor (the fixing screws must not bear any weight).
- Ensure that the guides are aligned both vertically and horizontally.
- Remove any dust and dirt from the Venetian blinds before using them.
- Mark the installation position box.
- Ensure that all scaffolding and auxiliary devices are safe to use.
- Fix the guides to materials with high dimensional stability.
- Work using only suitable and undamaged tools.
- Keep all packaging material and small parts out of reach of children: **DANGER OF SUFFOCATION!**

WARRANTY CONDITIONS:

Failure to follow the instructions provided by LUPAK METAL in the enclosed manual shall result in the warranty being rendered null and void. LUPAK METAL declines all responsibility for any direct or indirect damage or injury caused by the failure to follow the instructions or by replacing any supplied parts with unauthorised materials. The warranty conditions shall be understood to be tacitly accepted upon receipt of the invoice. Application of the warranty shall be determined at the discretion of LUPAK METAL authorised technicians.

DESCRIPTION OF LABELS

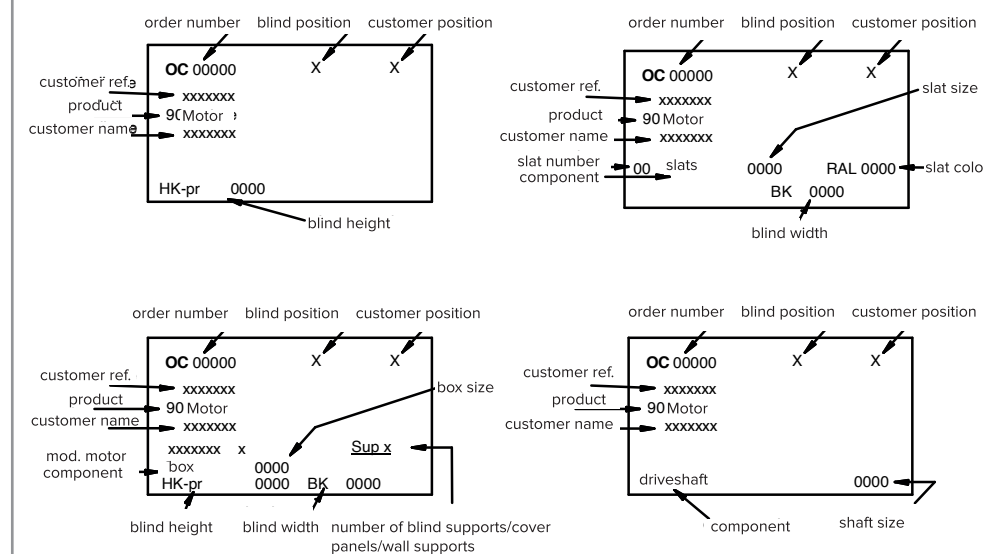

CAUTION
Failure to follow the instructions may put the user in danger

CAUTION
Failure to follow the instructions may lead to damage to the product

CAUTION
electrical danger

USEFUL INFORMATION

ABBREVIATIONS AND SYMBOLS KEY

TL = slat length
BL= clearance width
BK= guide external width
HK= blind height
HT= total opening height
HL= clearance height
HS= total recess height

HT= HL+HS

BEFORE INSTALLATION

- separate the material (based on how and where it will be installed).
- select the required tools.
- check the clearance dimensions of the blind and opening observing the tolerances.

GUIDE PROTECTION,
MOVE THE GUIDES ONLY UP AND DOWN WITH THE ANGLE BRACKET FACING UPWARDS.

INSTALLATION TOLERANCES:

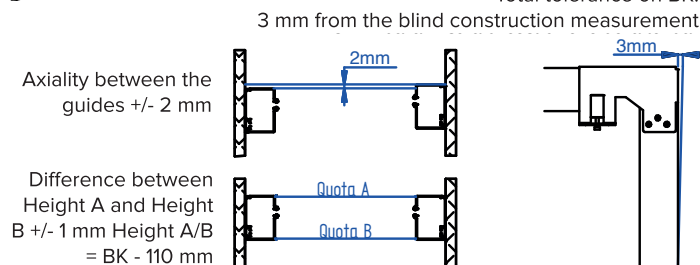

1 Centre the guides inside the recess / cover panel taking into account the slat overhang with respect to the guide.

2 Mark the holes in the centre of the slot.

3 Remove the guides and insert the screws where marked.

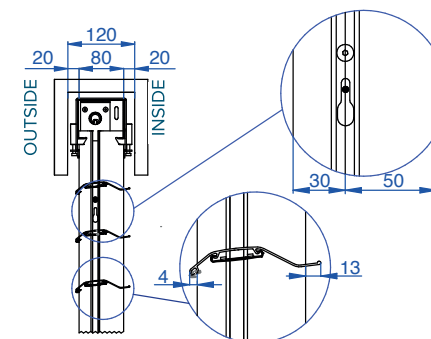

4 Keep the screws away from the wall by about 10 mm.

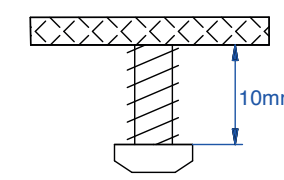

5 Measure the width from the outside of the guide (BK) for every fixing point, keeping the tolerances in mind.

$BK = TL + \Delta$
 $\Delta \approx 125\text{mm}$

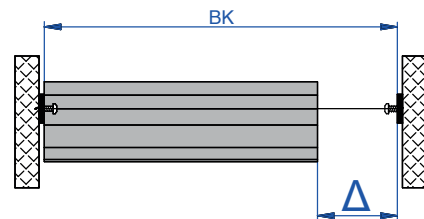

6 Split the difference between the external width of the guide with the supplied shims.

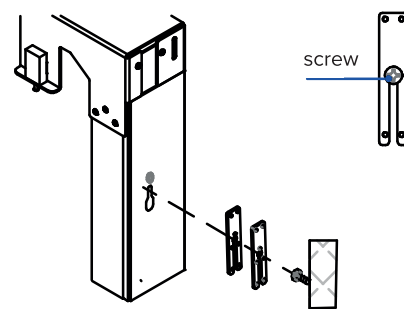

7 For more precise compensation, use the provided blue grub screws. MAX 2 mm per side.

The adjustment can be made even with the blinds already fitted.

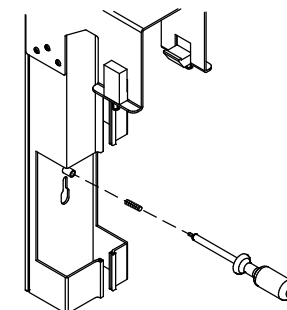

8 Insert the guides in the screws (1). Then move them downwards until the guides rest on the ground (2). Tighten the screws being careful not to apply too much torque.

ATTENTION!

The screws must be tightened by hand to avoid damaging the noise dampening seal.

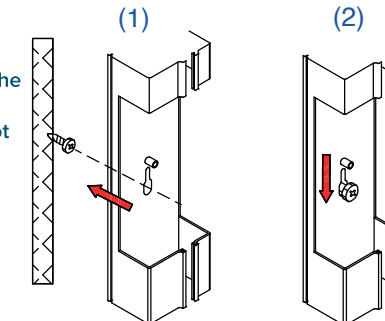

ATTENTION!

9 Check that the fixing screws are not too tight. Perform a check by inserting the supplied black taper key in the guide channel: It must have play.

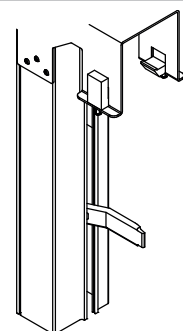

10 Position the guides, making sure that the tilter shafts are facing the right way, i.e. with the guide channel facing down. If not, simply reposition them manually, WITHOUT FORCING THE SYSTEM.

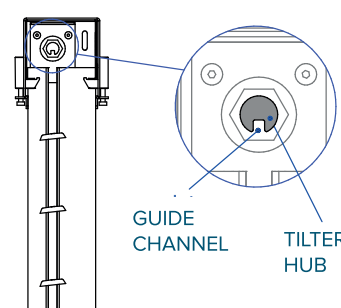

11 UNSCREW THE 4 SCREWS ON THE BOX BLOCK

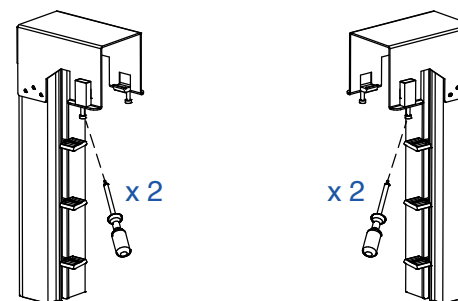

12 Install the head box paying attention to the INSIDE label. First, insert the side opposite the motor (1), lift the motor side (2) and, looking inside (3) move the box towards the right.

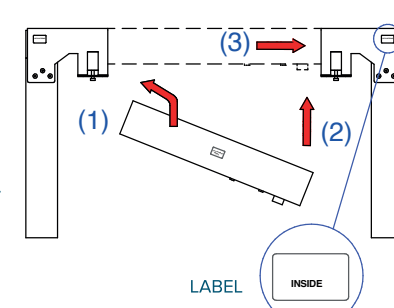

ATTENTION!

Ensure that the adapter is correctly inserted in the tilter hub.

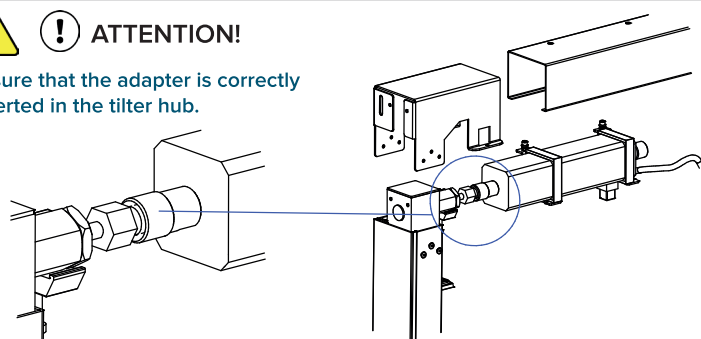

13 Make sure the box is aligned with the box feet on the side opposite the motor. If the blinds are fitted as per the tolerance, then the box will be flush with base plate or will protrude by a maximum of 3 mm towards the guide. Tighten the 4 base plate screws and secure the box.

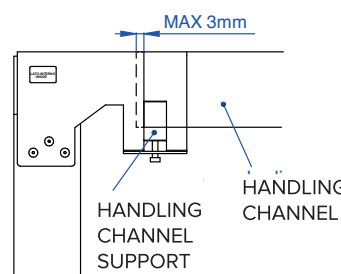

14 Insert the driveshaft universal joint into the drive (1). Then insert the drive into the motor adapter (2). Raise the side opposite the motor (3) and move the driveshaft universal joint by inserting it in the driveshaft extension. Tighten the grub screws.

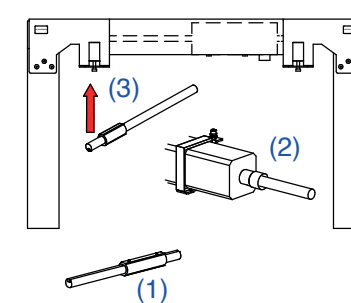

ATTENTION!

15 Connect the motor by connecting the motor plug to the provided plug. Fix the cables using the appropriate cable clamps, ensuring that the wires do not sag onto the blind.

ATTENTION!

DO NOT OPERATE THE BLINDS WITHOUT THE SLATS

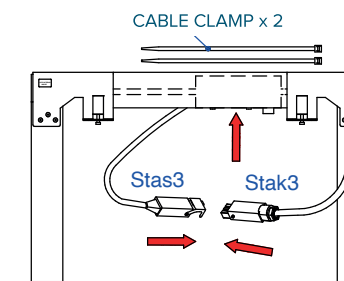

16 Position the slat stack bearing in mind that the rubber profile is fitted externally. Remove the packaging being careful not to scratch the slats.

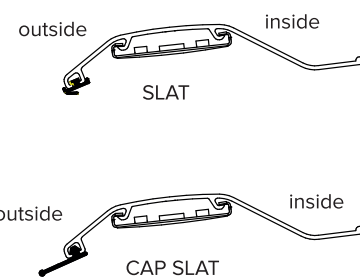

ATTENTION!

The slat with the adjustable profile should be fitted last, near the threshold.

17 Insert the CLIP sliding it in the slat guide channels.

ATTENTION!

The coupling tab must face the centre of the slat. Repeat this operation for each slat.

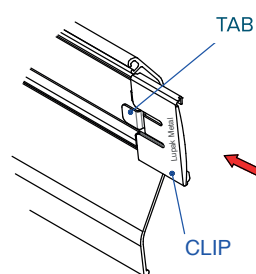

18 Starting from the top, rest the slat on the hooks and use the taper key to push the clip towards the hook. Insert the clip until the tab is positioned inside the hook seat. Repeat this operation for each slat. **ATTENTION:** Make sure the clip is inserted correctly, failure to do so will damage the system.

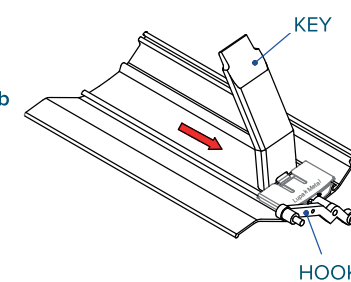

ATTENTION!

The slat must be fitted with the hooks in horizontal position. Ensure that the hook does not enter the guide channel.

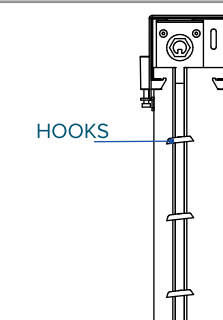

19 To keep the tolerance correct, keep a MAX 1mm from both sides between the slat edge and the hook edge.

ATTENTION!

Make sure there is play between the slats and the guides by moving them vigorously sideways, twice for each slat.

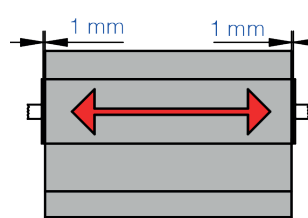

20 Trim the rubber profile of the last slat by making a small cut on the edge of the correct sector. Then, slowly pull the cut portion.

ATTENTION!

THIS OPERATION IS MANDATORY TO ALLOW THE SLAT TO TURN.

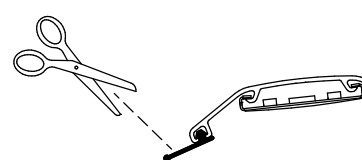

21 FINAL TESTING: When installation is completed, the blinds must first be drawn up until they reach the limit stop. Then, lower the blinds until they reach the bottom limit stop.

ATTENTION!

SOMFY motor: upwards limit stop BLACK key.

ELERO motor: upwards limit stop ORANGE key.

ATTENTION!

The bottom limit stop on the blinds must NOT be changed! The proper setting is made at the factory. ONLY THE UPWARD LIMIT STOP MAY BE CHANGED.

ATTENTION!

In the event of a blind malfunction, consult the troubleshooting table. TROUBLESHOOTING TABLE

SOMFY LIMIT STOP SETTINGS

- 1 Set the blinds at half height.
- 2 Press the black limit stop button on the motor.
- 3 Bring the blinds to the desired position.
- 4 Lower the blinds for 6 seconds.